

**PARTS LIST AND OPERATING INSTRUCTIONS  
FOR  
NUMBER 25 AND NUMBER 40 MOTOR DRIVEN  
AUTOMATIC CENTERING REEL**

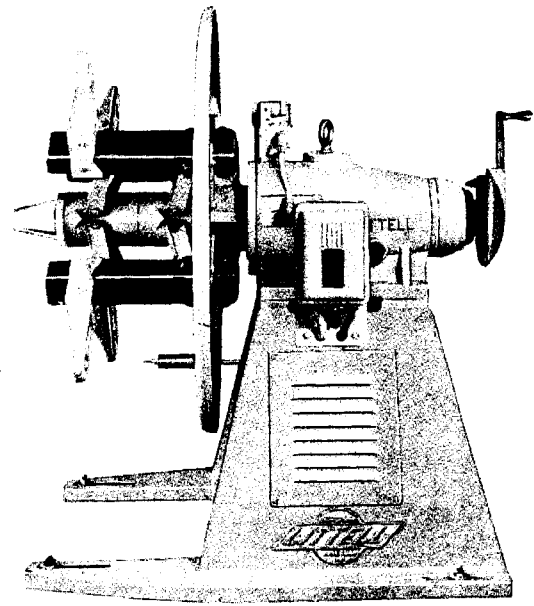
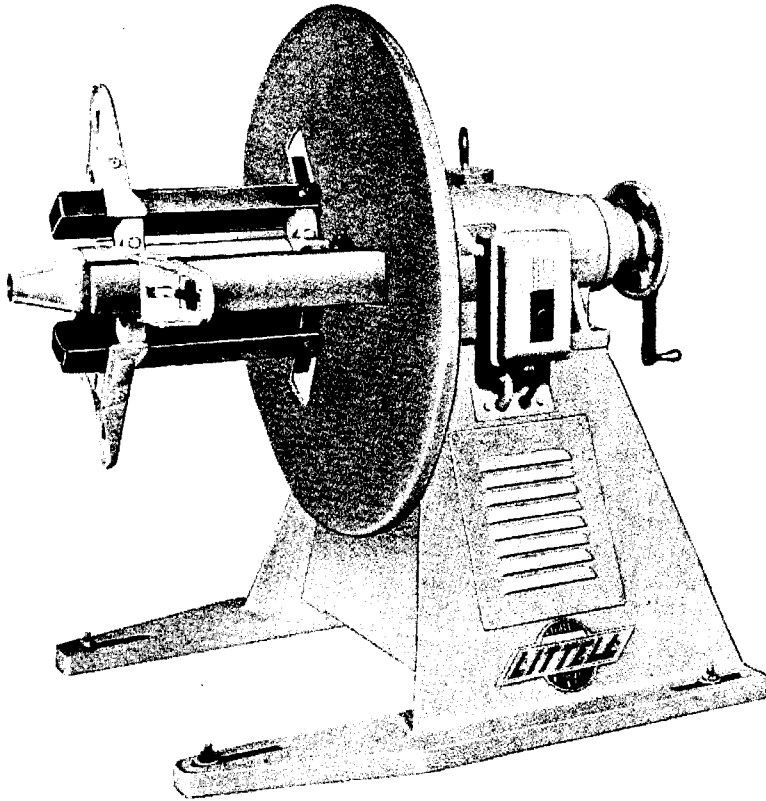

**CAPACITIES**

SIZE OF REEL	25-12	25-18	25-24	25-36	40-18	40-24	40-36
MAX WEIGHT OF COIL	2500 lbs	2500 lbs	2500 lbs	1500 lbs	4000 lbs	4000 lbs	3000 lbs
4 ARM INSIDE DIA.	16"-20" or 19"-24"	16"-20" or 19"-24"	16"-20" or 19"-24"	16"-20" or 19"-24"	16"-20" or 19"-24"	16"-20" or 19"-24"	16"-20" or 19"-24"
3 ARM INSIDE DIA.	12"-14"	12"-14"	12"-14"	12"-14"	12"-14"	12"-14"	12"-14"
MAX OUTSIDE DIA.	40"	40"	40"	40"	45"	45"	45"
MAX WIDTH	12"	18"	24"	36"	18"	24"	36"

**F. J. LITTELL MACHINE CO.**

4101 N. RAVENSWOOD AVENUE

CHICAGO, ILLINOIS 60613

Form No. 730-2-71

Page 1

**IMPORTANT**

When ordering repair parts, specify part number plus serial number, code number and size of machine. Send all repair parts orders to the Chicago factory.

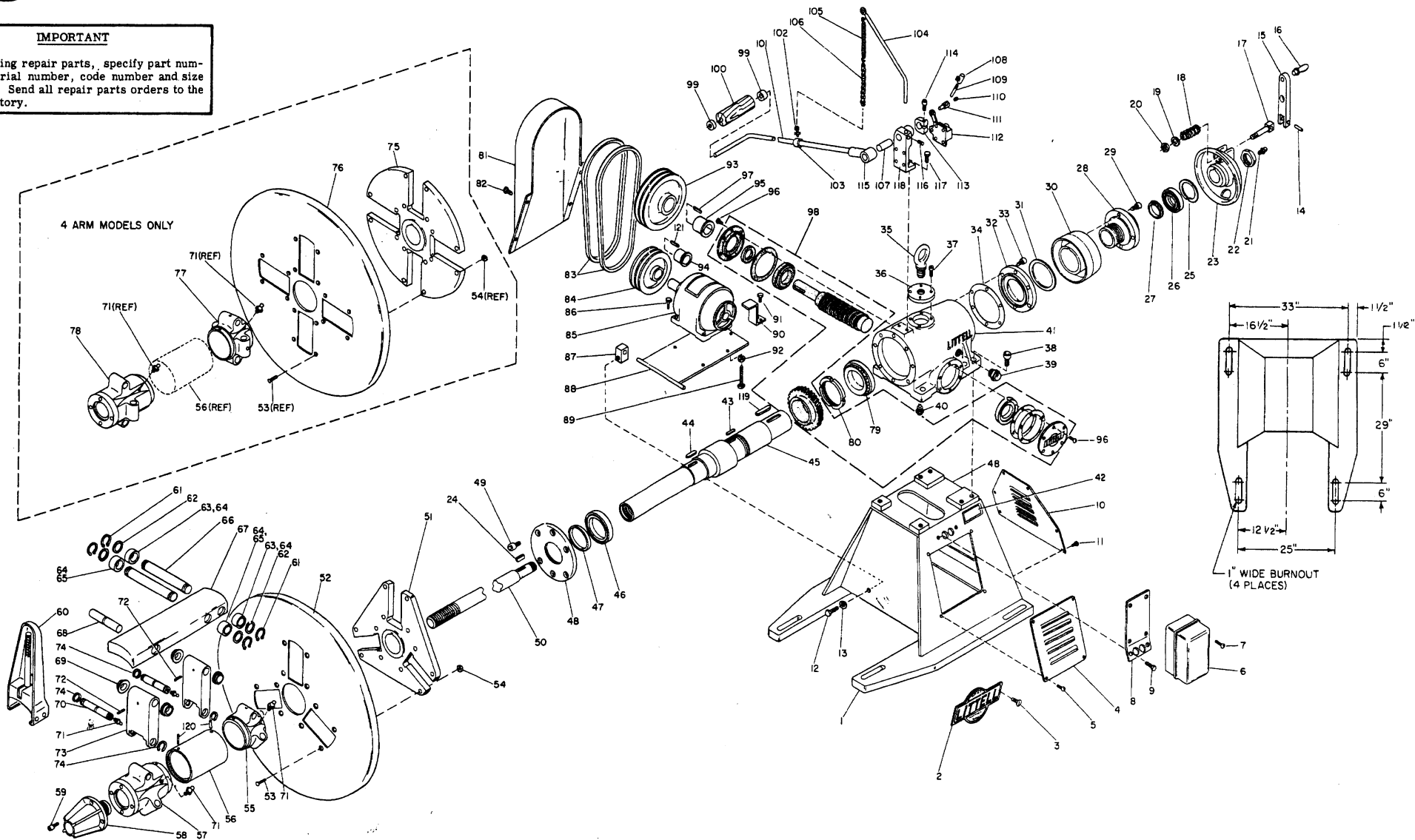

# No. 25 AND No. 40 MOTOR DRIVEN AUTOMATIC CENTERING REEL



## PARTS LIST

PLEASE SPECIFY WHETHER PARTS ARE BEING ORDERED FOR THE NO. 25 OR NO. 40 REEL.

INDEX NO.	DESCRIPTION	PART NUMBER
1	Base . . . . .	45D-25589
2	Nameplate, LITTELL . . . . .	24B-34003
3	Screw, Self-Tapping, Fl. Hd. Phillips . . . . . 1/4 x 3/4" Lg	000-00000
4	Plate, Base Cover . . . . .	45A-27508
5	Screw, Machine, Rd. Hd. . . . . 1/4 - 20 x 1/2" Lg	000-00000
6	Magnetic Starter, Size O . . . . .	92-91607
7	Screw, Machine, Rd. Hd. . . . . 1/4 - 20 x 3/8" Lg	000-00000
8	Bracket, Starter . . . . .	45A-44683
9	Bolt, Hex. Hd. 1/2 - 13 x 1" Lg . . . . .	000-00000
10	Plate, Base Cover . . . . .	45A-27509
11	Screw, Machine, Rd. Hd. . . . . 1/4 - 20 x 1/2" Lg	000-00000
12	Bolt, Hex. Hd. 1/2 - 20 x 1-3/4" Lg . . . . .	000-00000
13	Washer, Lock, 1/2" . . . . .	000-00000
14	Pin, Roll . . . . .	99-91982
15	Bar, Handle . . . . .	45B-25591
16	Handle . . . . .	42-90424
17	Pin, Handle Spring . . . . .	46A-35881
18	Spring . . . . .	46-90007
19	Washer, Flat 1/2" I.D. . . . .	000-00000
20	Nut, Self-Locking . . . . .	45-90959
21	Fitting, Grease 1/8 NPT . . . . .	000-00000
22	Nut, Jam 1 - 14 . . . . .	000-00000
23	Handwheel . . . . .	45C-25580
24	Key, Woodruff #15 . . . . .	000-00000
25	Ring, Retaining . . . . .	45-91418
26	Bearing, Ball . . . . .	99-91552
27	Bearing, Thrust . . . . .	45A-27502
28	Retainer, Bearing Adjust. Screw . . . . .	45B-25581
29	Screw, Cap, Socket Hd 3/8 - 16 x 1-3/4" Lg . . . . .	000-00000
30	Spacer . . . . .	45B-25573
31	Seal, Oil . . . . .	45-91562
32	Retainer, Bearing, Rear . . . . .	45-46084
33	Screw, Cap, Socket Hd 3/8 - 16 x 1-1/4 Lg . . . . .	000-00000
34	Shim Set . . . . .	45-91416
35	Eyebolt . . . . .	45A-35632
36	Cover, Gear Retainer . . . . .	45B-25579
37	Screw, Cap, Socket Hd 3/8 - 16 x 1-1/4" Lg . . . . .	000-00000
38	Screw, Cap, Socket Hd 3/4 - 10 x 2" Lg . . . . .	000-00000
39	Gage, Oil Level . . . . .	45-90848
40	Plug, Magnetic . . . . .	45-91548
41	Gear Case . . . . .	45D-25576
42	Nameplate . . . . .	45A-35728
43	Key, Worm Gear . . . . .	45A-41103
44	Key, Disc Hub . . . . .	45A-27503
45	Shaft, Spindle* . . . . .	45C-25555
46	Bearing, Roller . . . . .	99-90153
47	Seal, Oil . . . . .	45-91414
48	Retainer, Bearing, Front . . . . .	45C-25577
49	Screw, Cap, Socket Hd 1/2 - 13 x 1" Lg . . . . .	000-00000
50	Screw, Adjusting* . . . . .	45B-25560
51	Hub, Disc, 3 Arm . . . . .	45-28245
52	Plate, Guide, 3 Arm, No. 25 (42 in. dia) . . . . .	45-23972
52	Plate, Guide, 3 Arm, No. 40 (46 in. dia) . . . . .	45C-23971
53	Screw, Machine, Fl. Hd. . . . . 3/8 - 16 x 1-3/4" Lg	000-00000
54	Nut, Flex-Lock 3/8 - 16 . . . . .	000-00000
55	Sleeve, Rear, 3 Arm . . . . .	45C-25570
56	Tube, Spacer* . . . . .	45B-25594
57	Sleeve, Front, 3 Arm . . . . .	45C-25569
58	Nut, Adjusting Screw . . . . .	45C-25571
59	Screw, Cap, Socket Hd 3/8 - 16 x 1" Lg . . . . .	000-00000
60	Assembly, Keeper . . . . .	45C-17780
61	Ring, Retaining . . . . .	33-90011

INDEX NO.	DESCRIPTION	PART NUMBER
62	Washer, Roller . . . . .	14-23214
63	Roller, Arm, Beveled . . . . .	45A-24628
64	Bushing . . . . .	99-90346
65	Roller, Arm . . . . .	45A-35601
66	Pin, Roller . . . . .	45A-35602
67	Arm, Reel* . . . . .	45B-35589
68	Pin, Link . . . . .	45A-23959
69	Bushing, Arm . . . . .	45A-25568
70	Pin, Link, Lower . . . . .	45A-23969
71	Fitting, Grease 1/8 NPT . . . . .	000-00000
72	Pin, Roll . . . . .	45-91546
73	Link† . . . . .	45B-25582
74	Ring, Retaining . . . . .	33-90011
75	Hub, Disc, 4 Arm . . . . .	45C-25575
76	Plate, Guide, 4 Arm, Model No. 25 (42 in. dia) . . . . .	45C-25587
76	Plate, Guide, 4 Arm, Model No. 40 (46 in. dia) . . . . .	45-25588
77	Sleeve, Rear, 4 Arm . . . . .	45C-25567
78	Sleeve, Front, 4 Arm . . . . .	45C-25566
79	Bearing, Roller . . . . .	45-91415
80	Nut, Lock . . . . .	15-91212
81	Guard, Belt . . . . .	45B-41036
82	Screw, Machine Rd Hd. . . . . 1/4 - 20 x 3/8" Lg	000-00000
83	Belt, V-Type . . . . .	41-90765
84	Sheave . . . . .	45-91498
85	Motor, 1-1/2 HP, No. 25 . . . . .	91-90683
85	Motor, 2 HP, No. 40 . . . . .	91-90682
86	Bolt, Hex. Hd. 5/8 - 11 x 1-1/2" Lg . . . . .	000-00000
87	Bracket, Pivot . . . . .	45A-35595
88	Platform, Motor . . . . .	45B-35594
89	Screw, Sq. Hd. 5/8 - 11 x 3-1/4" Lg . . . . .	000-00000
90	Bracket, Hold Down, Plate . . . . .	45A-27405
91	Bolt, Hex. Hd. 3/8 - 16 x 1/2" Lg . . . . .	000-00000
92	Nut, Jam 5/8 - 11 . . . . .	000-00000
93	Sheave, Driven . . . . .	45-91499
94	Bushing, Split Taper .875" . . . . .	45-91479
95	Bushing, Split Taper 1.500" . . . . .	99-91480
96	Screw, Machine, Rd. Hd. . . . . 3/8 - 16 x 1" Lg	000-00000
97	Key, Feather Worm Gear . . . . .	41-41133
98	Worm and Gear Assembly . . . . .	45C-27524 (See Note)
--	Assembly, Control Arm . . . . .	45B-35713
99	Collar . . . . .	99-90438
100	Roller, Wood . . . . .	41A-35057
101	Arm, Control . . . . .	45A-24079
102	Eyebolt . . . . .	41A-35066
103	Collar . . . . .	23A-33506
104	Rod, Spring . . . . .	43A-35274
105	Spring . . . . .	41-90058
106	Chain . . . . .	41-90918
107	Pin, Control Arm . . . . .	45A-35609
108	Rod End . . . . .	46-90448
109	Link, Switch . . . . .	54A-36131
110	Setscrew 3/8 - 24 x 3/8" Lg . . . . .	000-00000
111	Pivot Block . . . . .	54A-36138
112	Switch, Limit . . . . .	93-90568
113	Lever, Switch . . . . .	54A-36206
114	Screw, Cap, Socket Hd . . . . . 1/4 - 28 x 1-1/4" Lg	000-00000
115	Rod End . . . . .	23-44966
116	Cap, Oiler . . . . .	15-90846
117	Bolt, Hex. Hd. 3/8 - 16 x 1" Lg . . . . .	000-00000
118	Bracket, Switch . . . . .	45A-35698
119	Key, Spacer . . . . .	99-49746
120	Pin, Roll . . . . .	45-91547
121	Key 3/16 sq. x 1-3/4" Lg . . . . .	000-00000

† Specify I.D. Required

\* Specify Whether For 12", 18" 24" or 36" Wide Reel

NOTE: This item is furnished as a set of matched parts.



## No. 25 AND No. 40 MOTOR DRIVEN AUTOMATIC CENTERING REEL

### OPERATING INSTRUCTIONS

A. ELECTRICAL CONNECTION. Connect the reel to the correct electrical voltage.

#### CAUTION

Be sure power source is correct for reel by checking motor nameplate for voltage requirement. Be sure that the power switch is in the "OFF" position.

B. REMOVE KEEPERS. Release keeper catch and remove keeper (60) from arms.

C. COLLAPSE ARMS.

(1) Turn crank handle (16) in a counterclockwise direction to collapse arms. The arms should be collapsed so that they are at least 1 or 2 inches smaller than the inside diameter of the coil to be loaded.

D. LOAD COIL.

- (1) Load coil using a coil loading hook. Suspend hook from a hoist and insert in coil.
- (2) Raise coil to proper height and slide onto the arms.
- (3) Remove loading hook.

E. ATTACH KEEPERS. Slide keepers (60) into position on the arms (67) so that the coil is tight against the guide plate (52) or (76).

F. EXPAND ARMS.

- (1) Unfold crank.
- (2) Turn hand crank in a clockwise direction. Turn crank until arms are fully extended against the coil.

G. AUTOMATIC OPERATION.

- (1) Remove the loose end of the coil from the top and pay it off by turning the switch to the "HAND" position.
- (2) Place a portion of the unwound coil under the control arm roller (100).
- (3) Deliver this portion of the coil to the using equipment.
- (4) Turn the switch to automatic position. When the arm is down, the motor will not operate and when the arm is up, the motor will operate to supply a free loop of stock.

H. REVERSAL OF HAND WHEEL OR PLACING EXPANDING WHEEL TO THE FRONT.

- (1) Item #58 which is the adjusting screw nut is removed by unscrewing the Hex Head cap screws.
- (2) The hand wheel crank is removed by unscrewing #22 jam nut, and the key #24 is removed.
- (3) The adjusting screw #50 is removed from the reel and reversed.
- (4) The adjusting screw nut #58 will then be fastened on the rear of the reel and the hand wheel will be placed on the front of the reel over key #24 and then nut #22 will be fastened or screwed onto what will be the front part of the shaft.

### MAINTENANCE INSTRUCTIONS

All Littell Reels are of very rigid construction and, if the capacities are not exceeded, will give years of trouble free service. Proper lubrication is the only maintenance required. Apply grease to grease fittings on spindle and on end of hand wheel.

GEAR CASE OIL. Medium heavy oil SAE 40 should be used in gear case. Remove eyebolt (35) and fill case to bring oil level up to the middle of sight gage (38).

**F. J. LITTELL MACHINE CO.**